

# University of Sussex Jubilee Building CASE STUDY

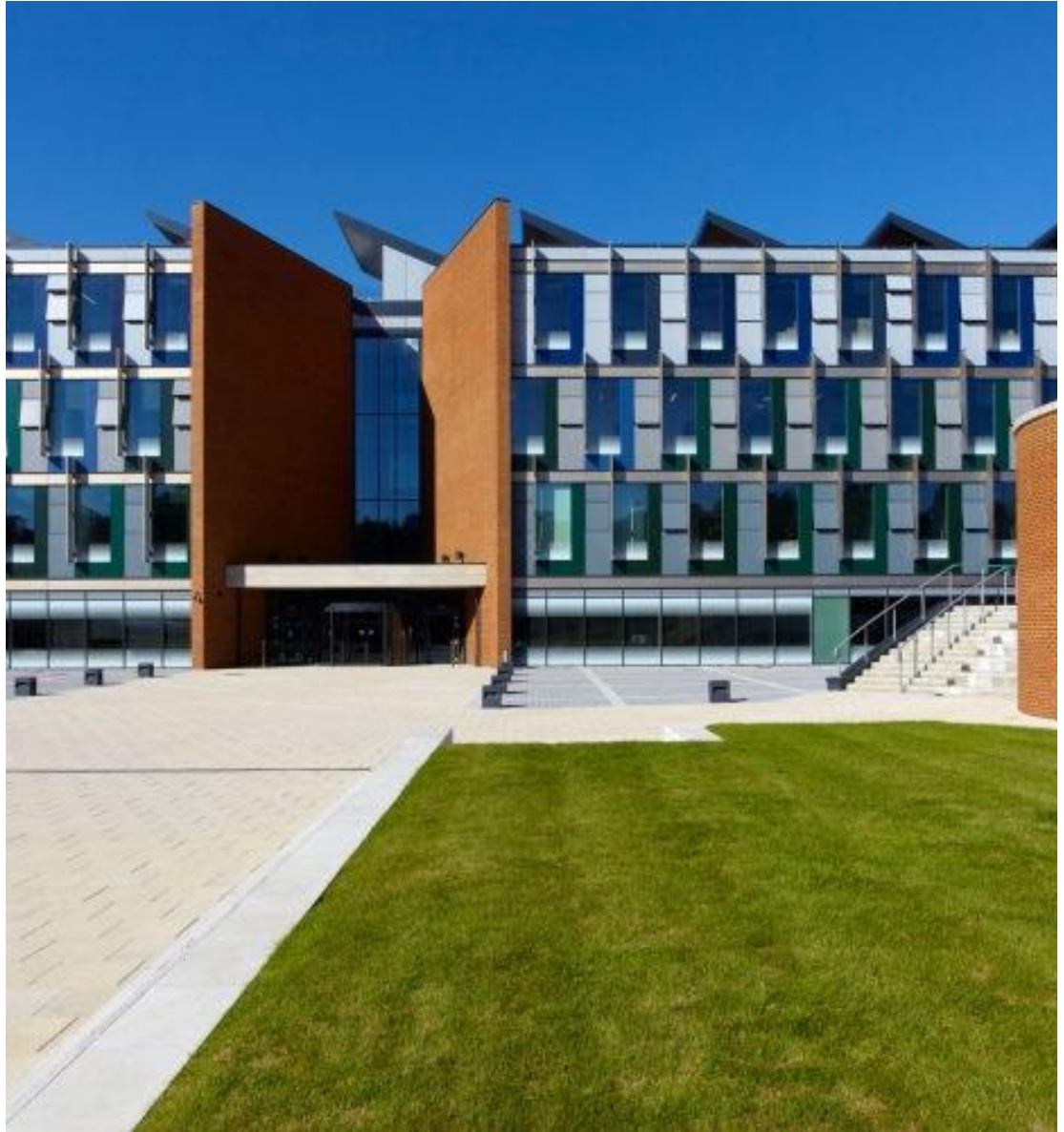

---

Location: **South**

M&E Contractor: **J B Hopkins**

Main Contractor: **Morgan Sindall**

Consultant: **Hoare Lee**

BMS System Installed: **Trend**

Value of Contract: **£380,000**

Completion: **October 2012**

---

## PROJECT FEATURES

- 3 MCC's & 25 Local Outstations
- Natural ventilation control over the floors
- FCU's & forced ventilation control within internal offices
- All linked back to main campus 963 supervisor

The Jubilee Building (formerly known as the new academic building) is a major new addition to the University's estate in the heart of campus for the benefit of staff and students. It includes a 500-seat lecture theatre (the largest on campus), both general and specialist teaching spaces, academic and support space, and social and café facilities.